

The Courses and Distances
down the River from the
post to the poplar are as
follow —

- N 25 W 99
- N 11 E 45
- N 38 E 72
- N 43 E 63
- N 48 E 62
- N 65 E 35
- S 84 E 37
- S 62 E 48 ✓
- S 29 E 18 ✓
- S 10 E 55
- S 45 E 49 ✓
- S 73 E 30 to the poplar.

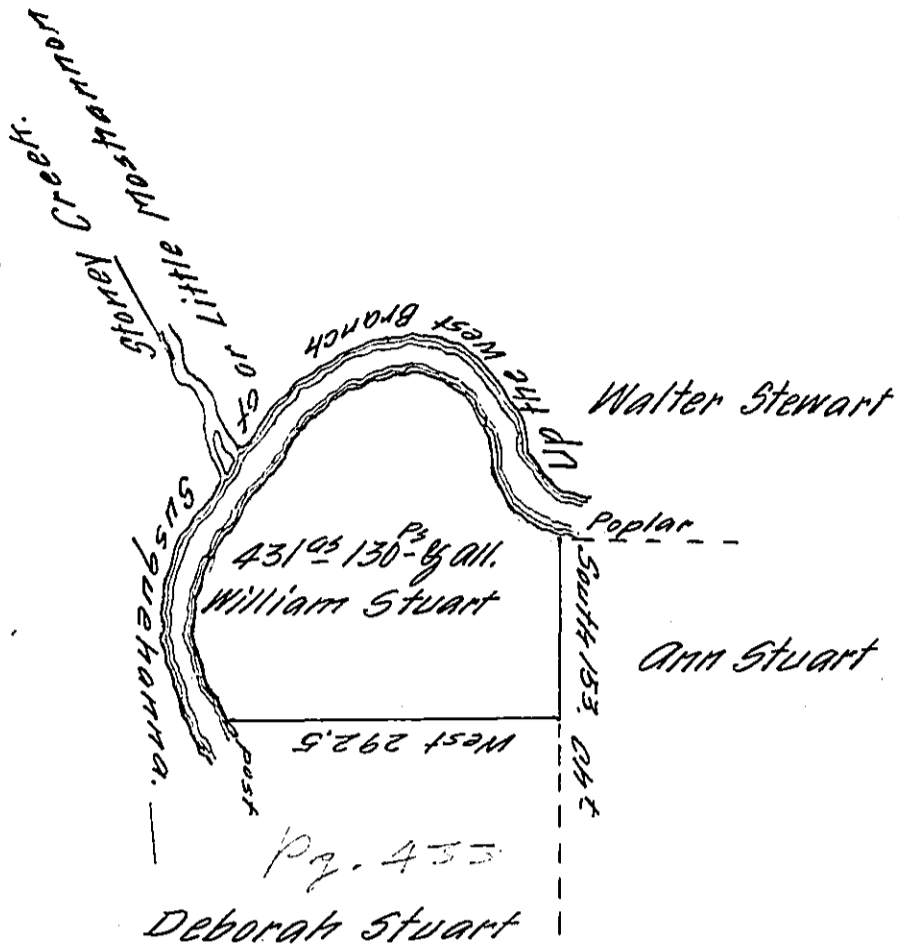

Situate in Mifflin County Upper Bald Eagle Town-
ship opposit the Mouth of Little Moshannon Creek
containing 431⁰³ 130⁰³ and the Usual allowance
for Roads —

Surveyed the 10th Day of November 1792 in per-
suance of a Warrant Dated the 31st Day of July
1792.

Jo. J. Wallis D.S.

Daniel Brodhead Esq^r S.G.

IN TESTIMONY that the above is a copy of the original remaining on file in
the Department of Internal Affairs of Pennsylvania, made
conformably to an Act of Assembly approved the 16th day of
February, 1833, I have hereunto set my Hand and caused
the Seal of said Department to be affixed at Harrisburg,
this eighteenth day of January 1912.

Henry Howell
Secretary of Internal Affairs.